

PROJECT LOCATION

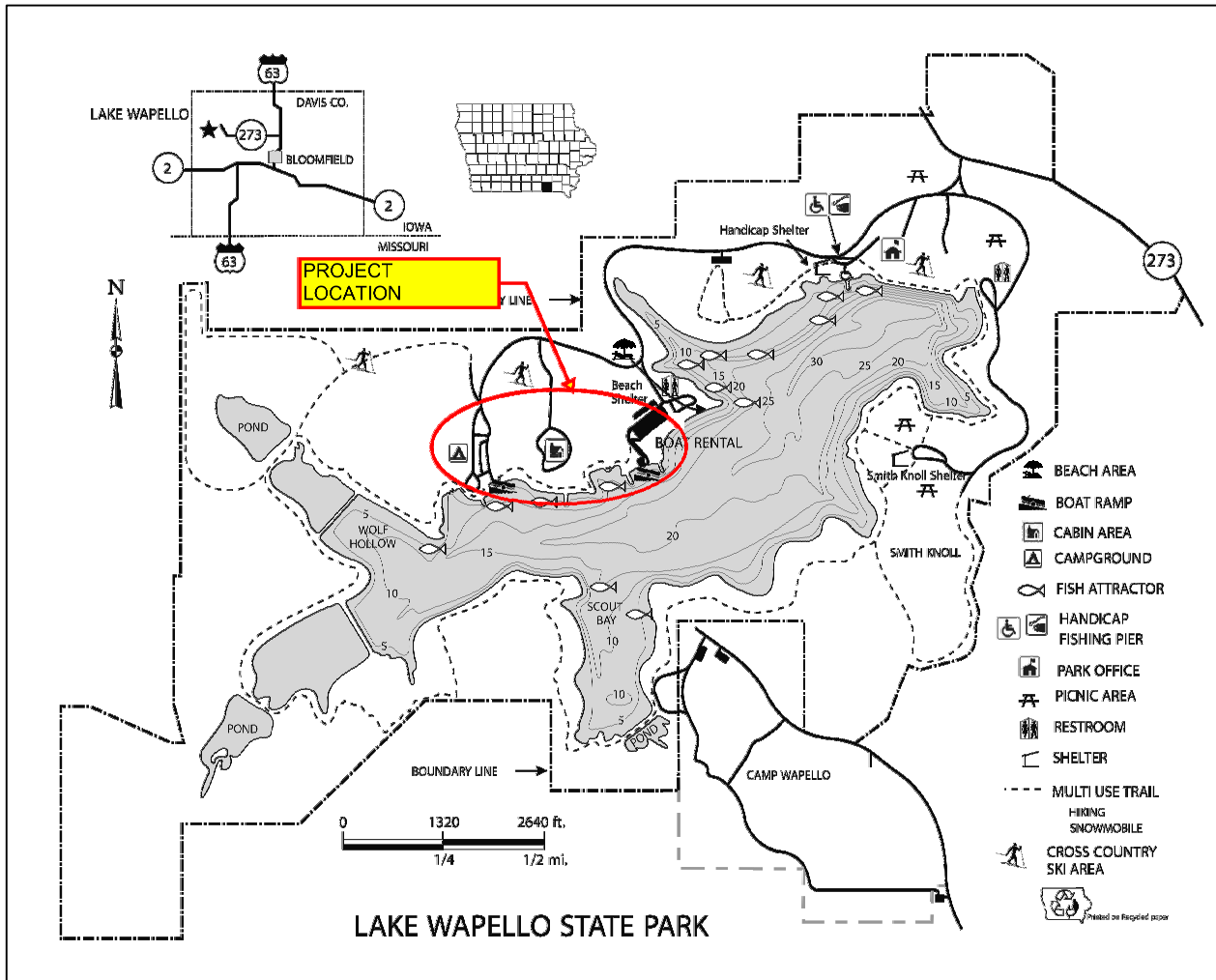

CONSULTANT:

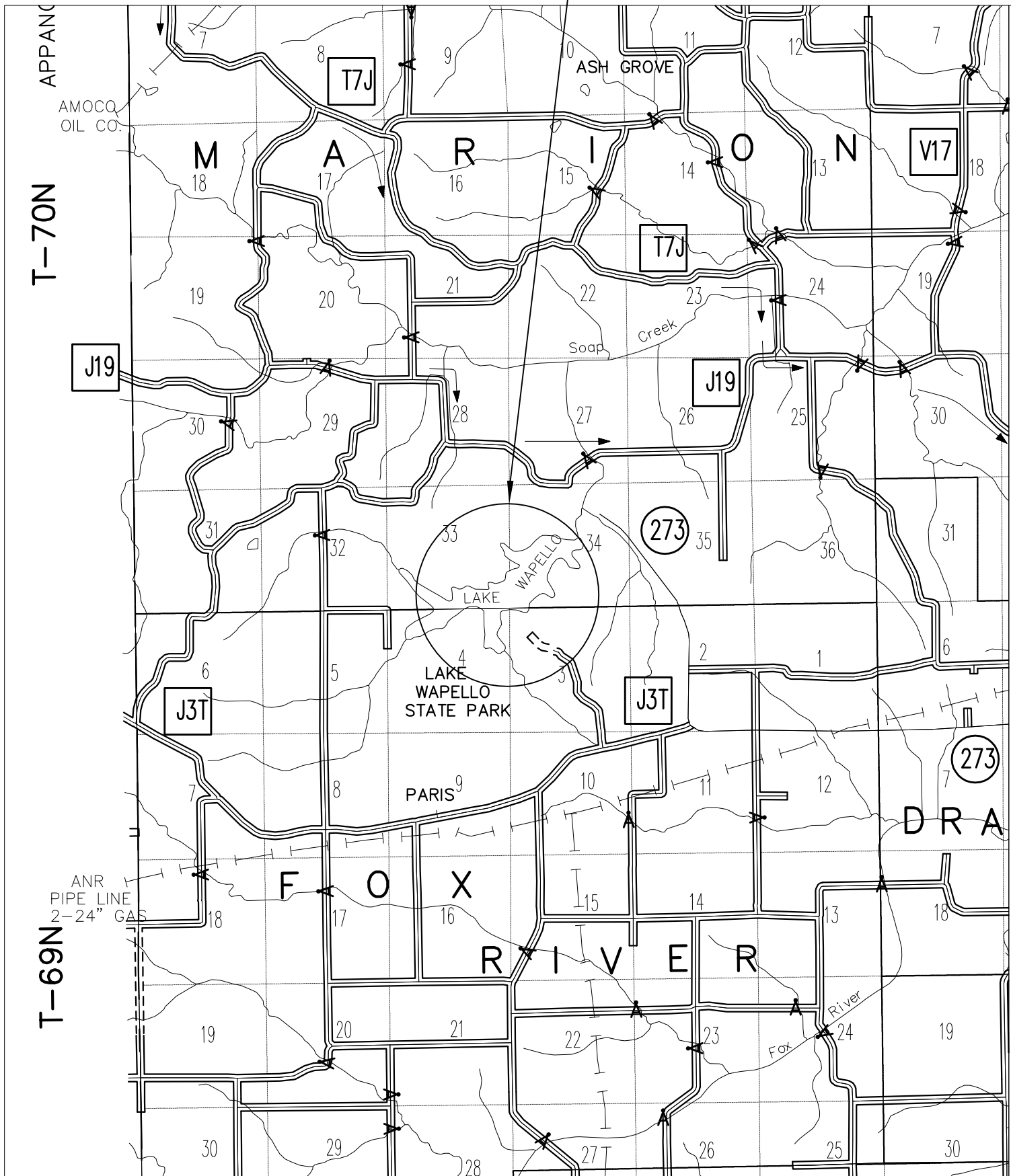
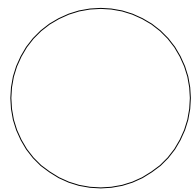

IOWA DEPARTMENT OF NATURAL RESOURCES

ENGINEERING SERVICES - WALLACE BUILDING
502 E. 9TH ST., DES MOINES, IA 50319-0034



PROJECT LOCATION

SANITARY SEWER LINING FOR:

LAKE WAPELLO STATE PARK

DAVIS COUNTY, IA

NO.	BY DATE	REVISION

DRAWN BY: ES
PROJECT NUMBER: 15-05-26-02

CHK'D BY: HM
DATE: AUG/2014

SHEET NO:

GENERAL NOTES:

1. The contractor shall notify the following 48 hr prior to construction:
 1. District Inspector:
Jason Kruse
(515)-250-3707
2. It is possible that there are utilities, the existence of which is presently not known or shown. It is the contractor's responsibility to determine their existence and exact location and to avoid damage thereto. No claims for additional compensation will be allowed to the contractor for any interference or delay caused by such work.
3. Do not interrupt existing utilities or individual services unless directed by the D.N.R Engineer or D.N.R Project Manager.
4. Locations of property easements and construction limits lines indicated on the plans are approximate.
5. Reset all property pins disturbed by the construction. Pins shall be reset by a land surveyor licensed in the state of Iowa cost is incidental to construction.
6. Provide and maintain access to private property at all times.
7. Protect all trees, utility poles, lines, fences, structures and other items from damage unless otherwise indicated to be removed. Replacement of any damaged items not indicated for removal during construction will be at contractor's expense.
8. The Contractor shall be responsible for keeping soil and debris deposited by construction activity off adjacent traffic lanes, parking lots, streets and drive ways.
9. Items of work indicated on the plans or specified that are not a specific bid item shall be considered incidental to construction.
10. The contractor shall provide access to the work at any time for the D.N.R Engineer, State/Federal /Local officials.
11. In accordance with Local, State and federal statutes, the contractor shall be solely and completely responsible for the conditions related to safety at the job site. This responsibility for safety of persons and property shall apply continuously and will not be limited to normal working hours.

SEWER REHABILITATION NOTES:

1. All sewer segments scheduled to be CIPP lined or chemical grouted shall be CCTV Televised after lining or grouting operations. An electronic copy of the televising records and reports shall be provided to the D.N.R Engineer.
2. All Existing Manholes scheduled for CCCM lining shall get new casting [er the specifications.
3. The Owner shall provide any potable water required at no cost. Contractor shall be required to provide the tank and vehicle to transport the water from the source. Owner gives no grantees that large flows will be available so filings may take sometime.
4. All cost for flow control, temporary pumping, etc shall be considered inclusive to associated work performed under the contract

CONSULTANT:

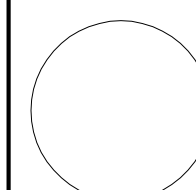

**IOWA DEPARTMENT OF
NATURAL RESOURCES**
ENGINEERING SERVICES - WALLACE BUILDING
502 E. 9TH ST., DES MOINES, IA 50319-0034



GENERAL NOTES

SANITARY SEWER LINING FOR:

LAKE WAPELLO STATE PARK

DAVIS COUNTY, IOWA

NO.	BY DATE	REVISION
DRAWN BY:	PROJECT NUMBER:	
ES	15-05-26-02	
CHK'D BY:	DATE:	
M.P.	AUG/2014	
SHEET No:		

3

NOTES:

ALL MANHOLES ARE BRICK INSTALL CCCM LINER AND NEW CASTING MANHOLE LINING WILL BE PAID BY ACTUAL VERTICAL FOOT.
 ALL 6"/8" SEWER PIPE (AS SHOWN) WILL BE LINED WITH CURED IN PLACE PIPE (CIPP) METHOD.
 ALL LATERALS WILL BE DUG & REPLACED WITH NEW 4" SDR 35 PVC PIPES. EXCEPT LATERAL C14
 POINT REPAIRS TO BE PERFORMED IN ACCORDANCE WITH SUDAS SPECIFICATION SECTION 4050
 ALL POINT REPAIRS TO BE DETERMINED IN FIELD BY THE D.N.R DISTRICT ENGINEER AND LINING CONTRACTOR.

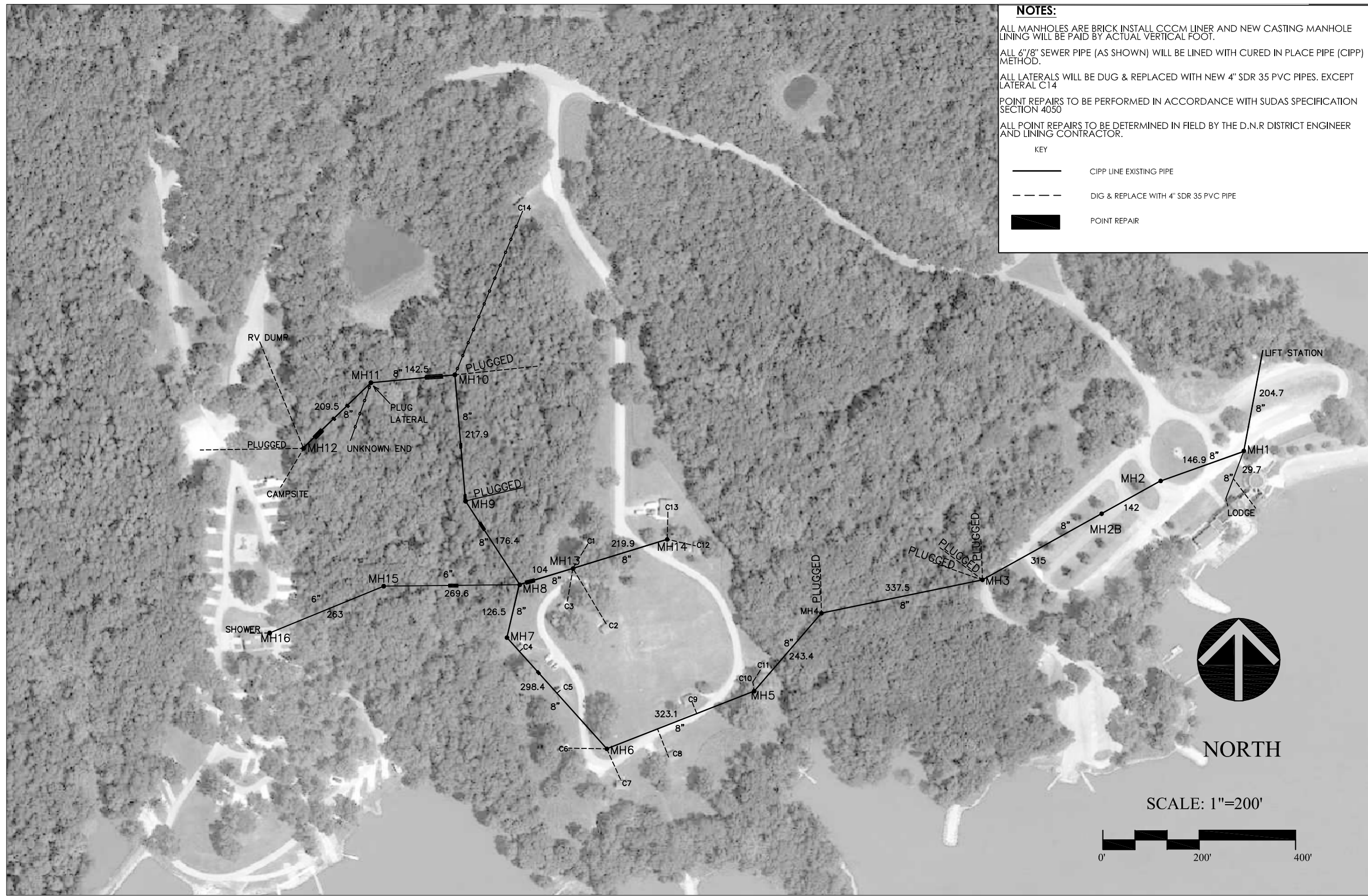
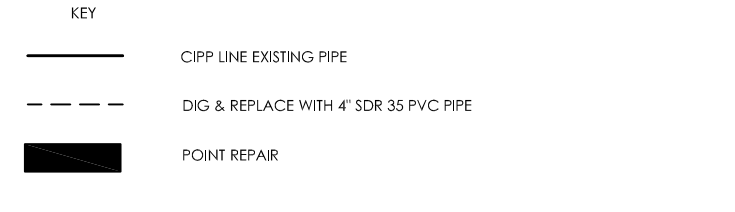

CONSULTANT:

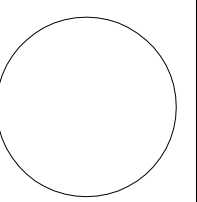

IOWA DEPARTMENT OF NATURAL RESOURCES

ENGINEERING SERVICES - WALLACE BUILDING
 502 E. 9TH ST., DES MOINES, IA 50319-0034



SITE PLAN

SEWER LINES UPGRADE FOR

LAKE WAPELLO STATE PARK

DAVIS COUNTY, IA

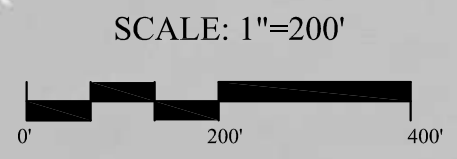

NO.	BY DATE	REVISION

DRAWN BY: ES PROJECT NUMBER: 15-05-26-02
 CHKD BY: MJH DATE: AUG /2014

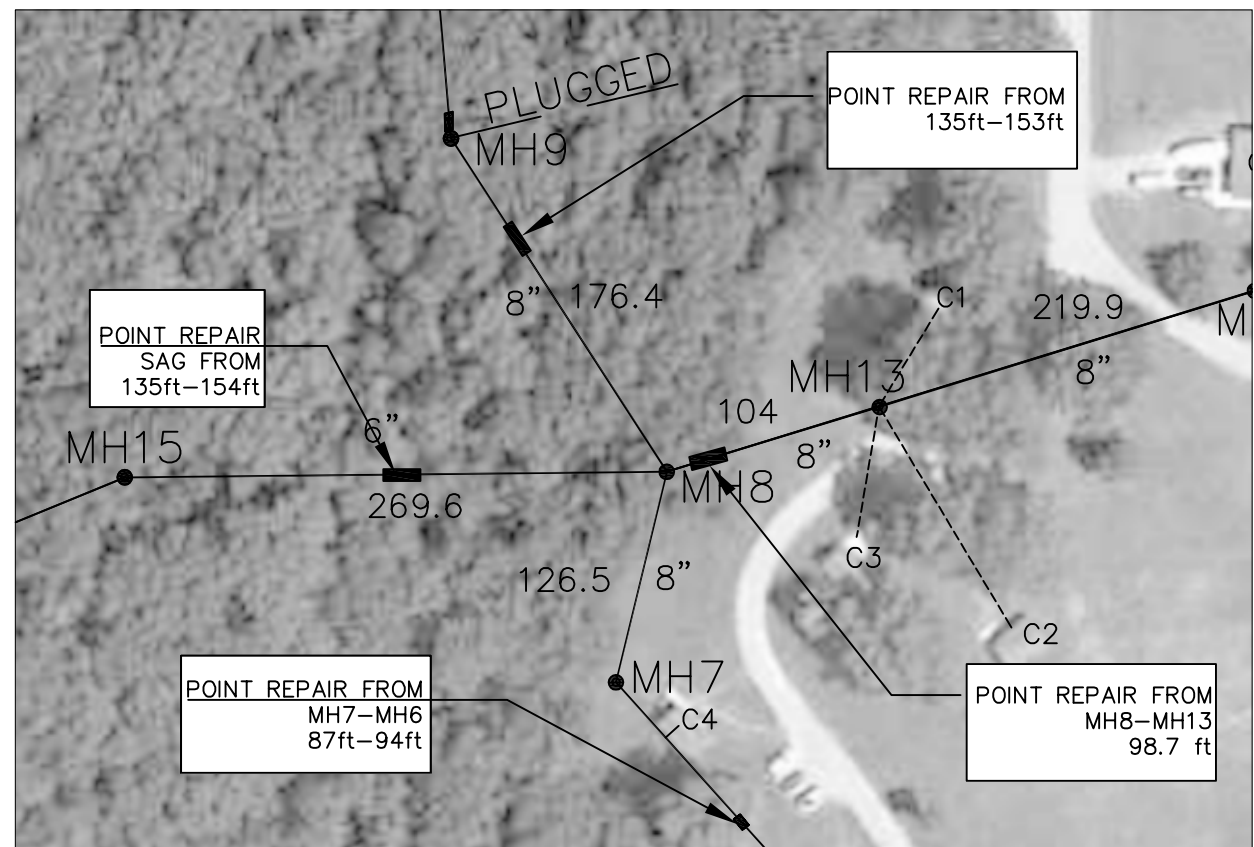
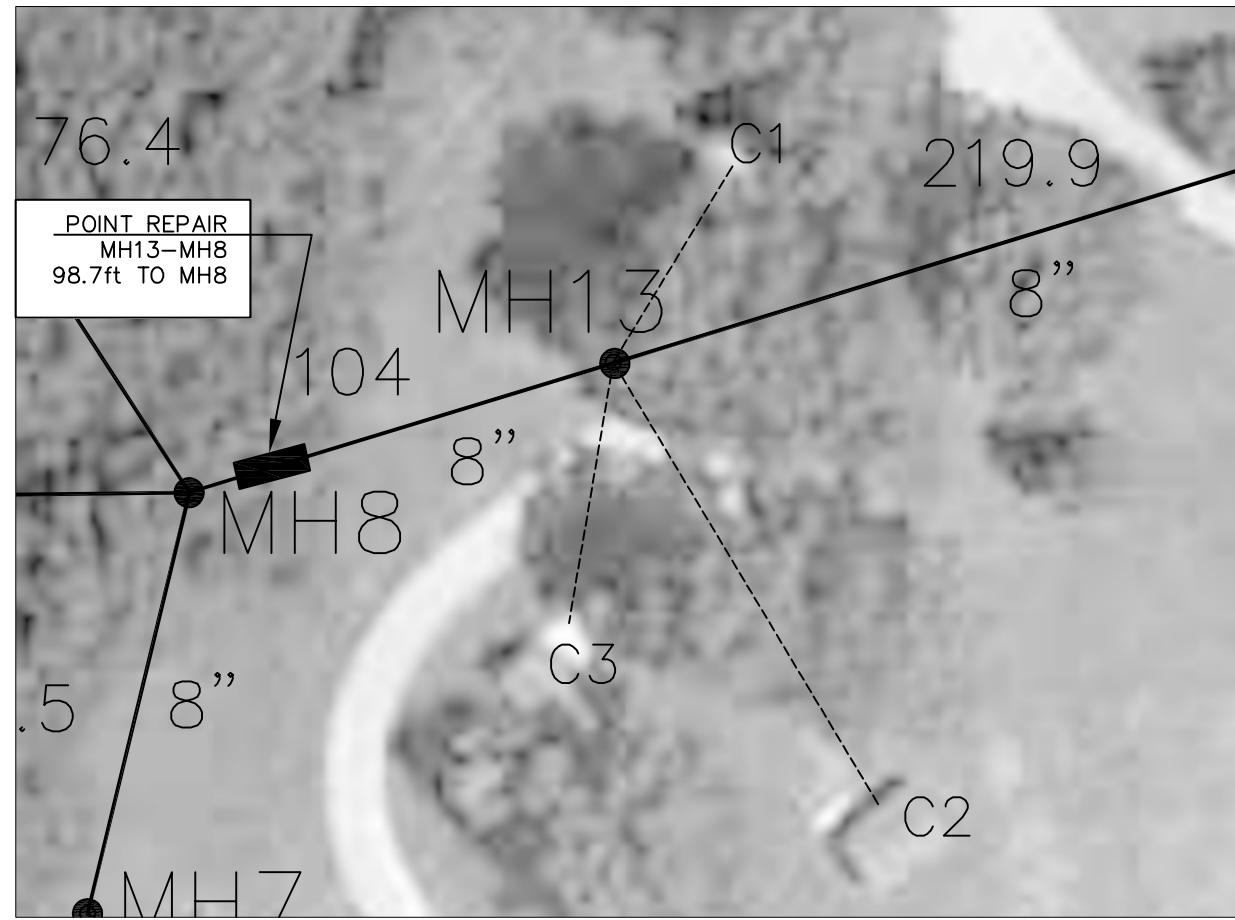
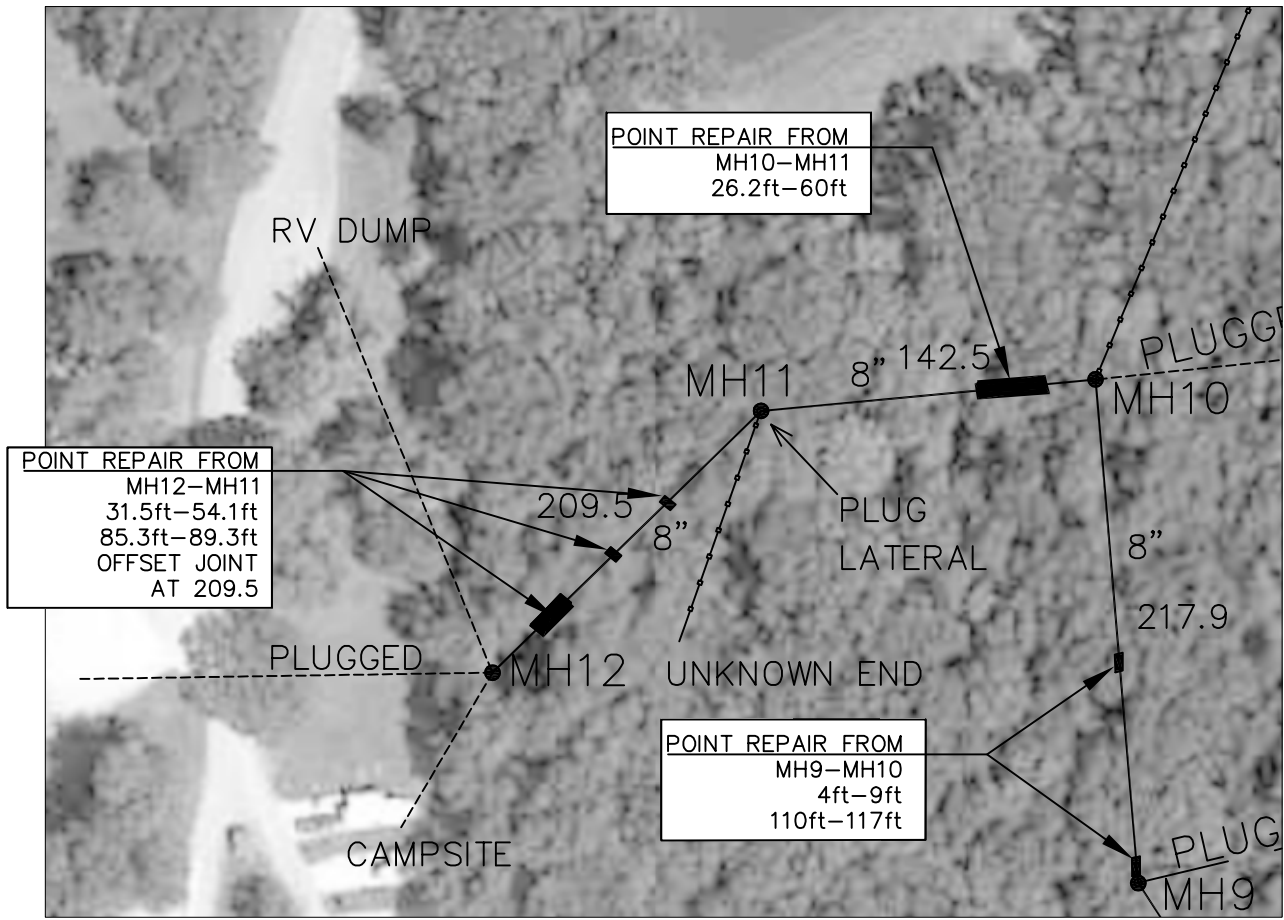

CONSULTANT:

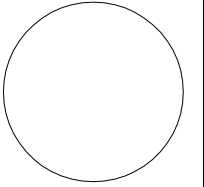

IOWA DEPARTMENT OF
NATURAL RESOURCES
ENGINEERING SERVICES - WALLACE BUILDING
502 E. 9TH ST., DES MOINES, IA 50319-0034



PLAN DETAILS FOR POINT REPAIRS

SANITARY SEWER LINING FOR

LAKE WAPELLO STATE PARK

DAVIS COUNTY, IA

NO.	BY DATE	REVISION

DRAWN BY: PROJECT NUMBER:
ES 15-05-26-02

CHKD BY: DATE:
MH AUG /2014

SHEET No: